

CURVE TABULATION					
NO.	RADIUS	DELTA	LENGTH	BEARING	DIST
C1	120.00	20°14'01"	42.38'	S62°08'10"E	42.16'
C2	300.00	12°45'44"	66.82'	S45°38'18"E	66.68'
C3	85.00	125°37'02"	186.36'	S77°35'11"W	151.21'
C4	300.00	41°11'10"	215.65'	N35°22'18"E	211.04'
C5	200.00	35°59'48"	125.65'	S37°57'57"W	123.80'
C6	175.00	61°45'13"	188.62'	N50°50'40"E	179.62'
C7	150.00	56°09'03"	147.00'	S53°38'45"W	141.19'
C8	300.00	46°05'24"	241.33'	N48°36'55"E	234.87'
C9	300.00	17°43'15"	92.79'	S62°47'59"W	92.42'
C10	500.00	9°38'01"	84.07'	N58°45'22"E	83.97'
C11	250.00	44°13'00"	192.93'	N85°40'53"W	186.18'
C12	500.00	7°43'25"	87.40'	N76°04'20"W	87.35'
C13	500.00	12°16'28"	107.11'	S73°47'48"E	106.91'
C14	85.00	99°17'14"	147.30'	S63°06'22"W	129.55'
C15	250.00	52°42'00"	229.95'	S12°53'15"E	221.93'
C16	2500.00	8°11'06"	357.14'	N35°08'42"W	356.84'
C17	2500.00	8°39'32"	290.55'	S34°22'54"E	290.39'
C18	200.00	58°52'20"	205.50'	N08°18'31"W	196.58'
C19	450.00	26°50'10"	210.77'	S07°44'34"W	208.85'
C20	400.00	32°49'54"	229.21'	N10°44'26"E	226.08'
C21	1500.00	5°50'13"	152.81'	S24°14'16"W	152.75'
C22	500.00	27°19'31"	238.46'	N34°58'55"E	236.21'
C23	600.00	14°57'25"	156.63'	S41°09'59"W	156.18'
C24	750.00	10°35'23"	138.62'	N38°58'58"E	138.42'
C25	200.00	5°54'27"	20.62'	S41°19'28"W	20.61'
C26	250.00	43°02'43"	187.82'	N59°53'34"E	183.43'
C27	200.00	12°02'58"	42.06'	S75°23'26"W	41.98'
C28	300.00	9°50'30"	51.53'	S64°26'42"W	51.47'
C29	750.00	8°47'44"	115.13'	N63°55'19"E	115.02'
C30	150.00	29°48'26"	78.04'	N83°13'24"E	77.16'
C31	750.00	14°14'57"	186.52'	S74°44'54"E	186.04'
C32	550.00	10°54'56"	104.78'	S66°24'39"E	104.62'
C33	300.00	21°02'17"	110.15'	S88°31'41"W	109.54'
C34	75.00	47°49'21"	62.60'	S54°05'53"W	60.80'
C35	100.00	9°45'11"	17.02'	S25°18'37"W	17.00'
C36	150.00	37°17'22"	97.62'	N39°04'42"E	95.91'
C37	550.00	11°31'18"	110.60'	N63°29'02"E	110.41'
C38	200.00	18°50'40"	65.78'	S59°49'21"W	65.48'
C39	450.00	12°45'46"	100.24'	S41°36'35"W	100.03'
C40	150.00	45°26'48"	118.98'	N57°57'06"E	115.88'
C41	100.00	129°19'55"	225.73'	S16°00'32"W	180.77'
C42	8.00	117°59'51"	16.48'	N01°41'30"E	13.71'
C43	200.00	12°39'20"	44.18'	N67°01'06"E	44.09'
C44	30.00	58°35'21"	30.68'	S44°03'05"W	29.36'
C45	15.00	82°04'17"	21.49'	S26°16'44"E	19.70'
C46	12.50	132°43'05"	28.95'	N07°22'08"W	22.90'
C47	100.00	18°14'28"	31.84'	S49°52'11"W	31.70'
C48	15.00	100°36'17"	26.34'	S09°33'11"E	23.08'
C49	200.00	10°19'58"	36.07'	S65°01'19"E	36.02'
C50	50.00	33°33'21"	29.28'	N50°36'07"W	28.87'
C51	20.00	85°35'48"	29.88'	S76°37'21"E	27.18'
C52	85.00	22°22'15"	33.19'	S71°45'53"W	32.98'
C53	20.00	59°30'15"	20.77'	N67°17'53"W	19.85'

LINE TABULATION		
NO.	BEARING	DIST
L1	S39°36'18"E	145.23'
L2	N14°46'41"E	98.69'
L3	N55°57'51"E	67.71'
L4	N19°58'03"E	143.63'
L5	N81°43'18"E	382.37'
L6	N25°34'13"E	101.63'
L7	N63°34'23"E	141.47'
L8	S72°12'37"E	191.56'
L9	S67°39'35"E	160.31'
L10	N44°18'39"E	139.79'
L11	N38°22'12"E	197.51'
L12	N69°21'57"E	174.82'
L13	N59°31'27"E	250.84'
L14	N30°11'13"E	65.46'
L15	N50°24'01"E	195.30'
L16	N47°59'28"E	534.72'
L17	S57°18'28"E	76.83'
L18	S73°20'46"W	55.02'
L19	S67°18'51"E	82.74'
L20	S73°43'41"E	47.16'
L21	S58°59'24"W	56.51'
L22	S59°51'20"E	79.66'
L23	S70°11'18"E	62.98'
L24	S67°22'48"E	74.70'
L25	S33°49'27"E	38.19'
L26	N82°57'00"E	26.29'
L27	S37°32'45"E	12.54'
L28	S26°36'26"E	10.00'

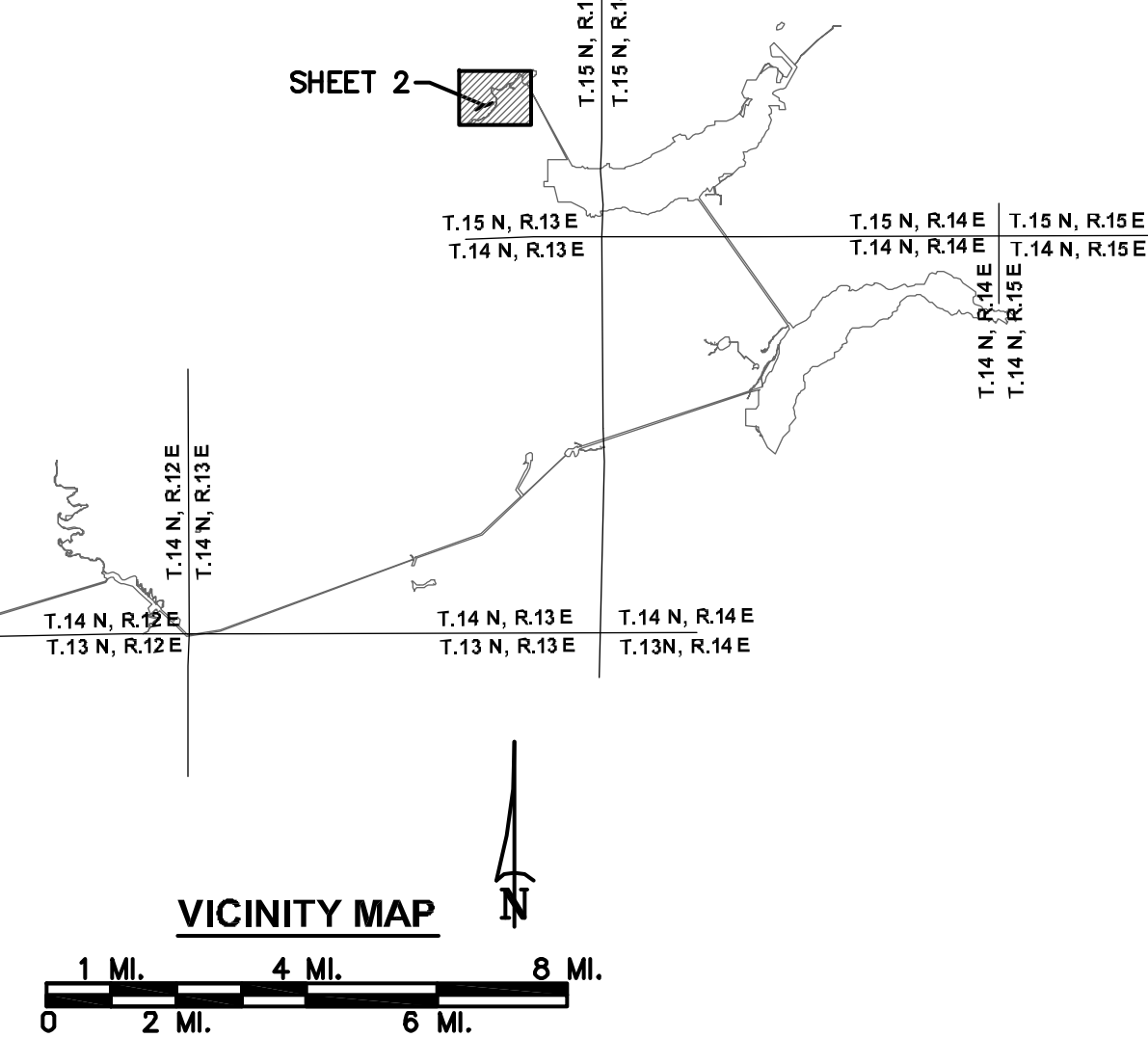
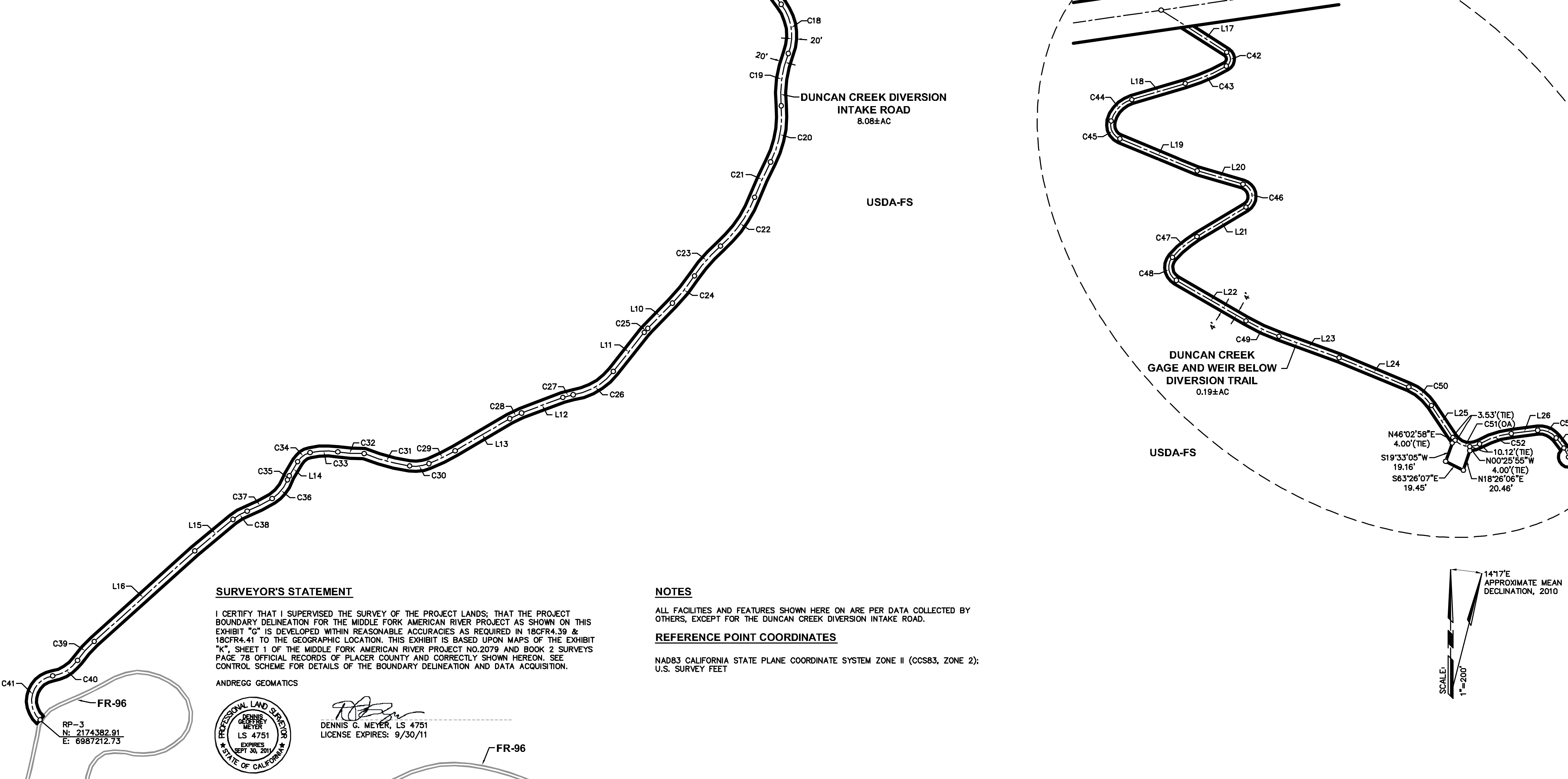

- LEGEND**
- PROJECT BOUNDARY
 - RESERVOIR STORAGE STAGE
 - TUNNEL (WITH SHAFT)
 - SECTION LINE, ESTABLISHED
 - SECTION LINE, PROTRACTED
 - SUBDIVISION LINE, GOVERNMENT LAND SURVEY
 - ◆ SECTION CORNER, FOUND
 - ◆ SECTION CORNER, RECORD
 - 1/4 CORNER, FOUND
 - 1/4 CORNER, RECORD
 - COUNTY LINE
 - U.S. FOREST BOUNDARY
 - PROJECT BOUNDARY CORNER
 - (OA) OVERALL DIMENSION
 - RP REFERENCE POINT
 - V PUBLIC LAND
 - ROAD
 - BRIDGE
 - RIVER OR PERENNIAL STREAM
 - INTERMITTENT STREAM
 - SPRING
 - POND OR LAKE, WATER LEVEL JULY 1961
 - TREES OR BRUSH
 - STREAM FLOW GAGING STATION
 - WATER SURFACE GAGING STATION
 - CAMPGROUND
 - BUILDING
 - GOVERNMENT BENCH MARK
 - BENCH MARK RELOCATION
 - PHOTOGRAMMETRIC PRINCIPAL POINT
 - TRIANGULATION STATION
 - 4121.2 FIELD ESTABLISHED ELEVATION
 - x 97 PHOTOGRAMMETRIC ELEVATION
 - M R O MINERAL RIGHTS ONLY
 - (1) RECORD PER 2 ROS 78

SURVEYOR'S STATEMENT

I CERTIFY THAT I SUPERVISED THE SURVEY OF THE PROJECT LANDS; THAT THE PROJECT BOUNDARY DELINEATION FOR THE MIDDLE FORK AMERICAN RIVER PROJECT AS SHOWN ON THIS EXHIBIT "G" IS DEVELOPED WITHIN REASONABLE ACCURACIES AS REQUIRED IN 18CFR4.39 & 18CFR4.41 TO THE GEOGRAPHIC LOCATION. THIS EXHIBIT IS BASED UPON MAPS OF THE SURVEY "K", SHEET 1 OF THE MIDDLE FORK AMERICAN RIVER PROJECT NO.2079 AND BOOK 2 SURVEYS PAGE 78 OFFICIAL RECORDS OF PLACER COUNTY AND CORRECTLY SHOWN HEREON. SEE CONTROL SCHEME FOR DETAILS OF THE BOUNDARY DELINEATION AND DATA ACQUISITION.



DENNIS G. MEYER, LS 4751
LICENSE EXPIRES: 9/30/11

NOTES

ALL FACILITIES AND FEATURES SHOWN HERE ON ARE PER DATA COLLECTED BY OTHERS, EXCEPT FOR THE DUNCAN CREEK DIVERSION INTAKE ROAD.

REFERENCE POINT COORDINATES

NAD83 CALIFORNIA STATE PLANE COORDINATE SYSTEM ZONE II (CCS83, ZONE 2); U.S. SURVEY FEET

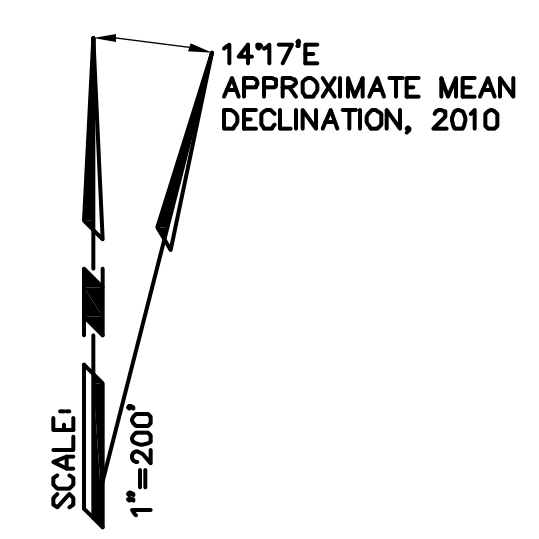

EXHIBIT 'G' PROJECT 2079
MIDDLE FORK AMERICAN RIVER PROJECT
DUNCAN CREEK DIVERSION ACCESS ROAD
 A PORTION OF SECTION 23, 24 & 26, T.15 N., R.13 E., M.D.M.
 PLACER COUNTY, CALIFORNIA
 SCALE: 1"=200' FEBRUARY 11, 2011

ANDREGG GEOMATICS
 www.andregg.com
 800-800-1077

50 100 200 400 600
 0 100 200 400 600

SHEET 2 OF 33